

RVH9301

APRON-FRONT WORKSTATION SINK

RUVATI[®]
SPECIFICATION SHEET

MATERIAL

True 16 Gauge Thickness
Premium T304 Grade Stainless Steel
18/10 Chromium/Nickel Content
Commercial Brushed Finish

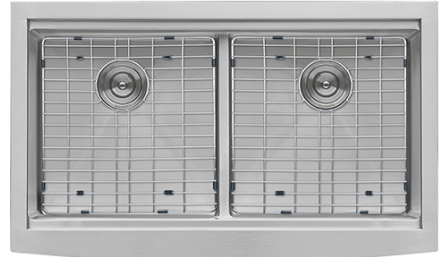

FEATURES

- Heavy duty sound guard padding and undercoating
- Slanted bottom with elegant drain grooves for easy draining
- Single-Tier Ledge for Accessories

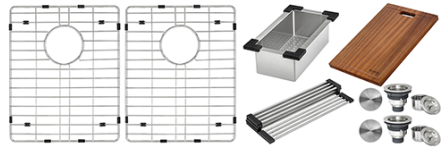

IN THE BOX

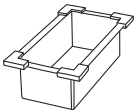

Colander
[RVA1327]

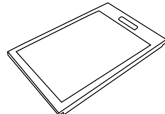

Cutting Board
[RVA1217]

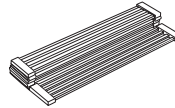

Folding Rack
[RVA1395]

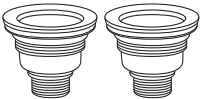

Basket Strainer
[RVA1025] x 2



Drain Cover
[RVA1035] x 2

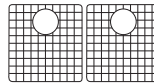

Rinse Grid
[RVA69301]

NOMINAL DIMENSIONS

Exterior: 36" (wide) x 22" (front-to-back)
Interior Bowl: 16" x 16" (left), 16" x 16" (right)
Bowl Depth: 10" | Front Apron Height: 9"
Minimum Cabinet Size: 39" wide
Drain Hole Size: 3-1/2"

Installation Type:
Apron-Front

Inside Corners:
Rounded

Drain Location:
Rear Center

RUVATI USA

www.ruvati.com

Phone: 1.855.478.8284
Email: support@ruvati.com

OPTIONAL ACCESSORIES (SOLD SEPARATELY)



Deep Basket
Disposal Flange
[RVA1049ST]

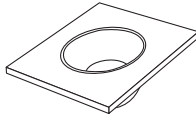

Mixing Bowl
and Platform
[RVA1288]

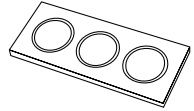

Condiment
Serving Tray
[RVA1377]

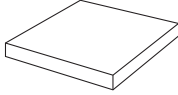

Butcher Block
[RVA2445ACA]

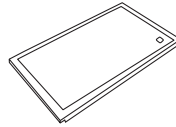

Black Plastic
Cutting Board
[RVA1217BLK]

DIMENSIONS

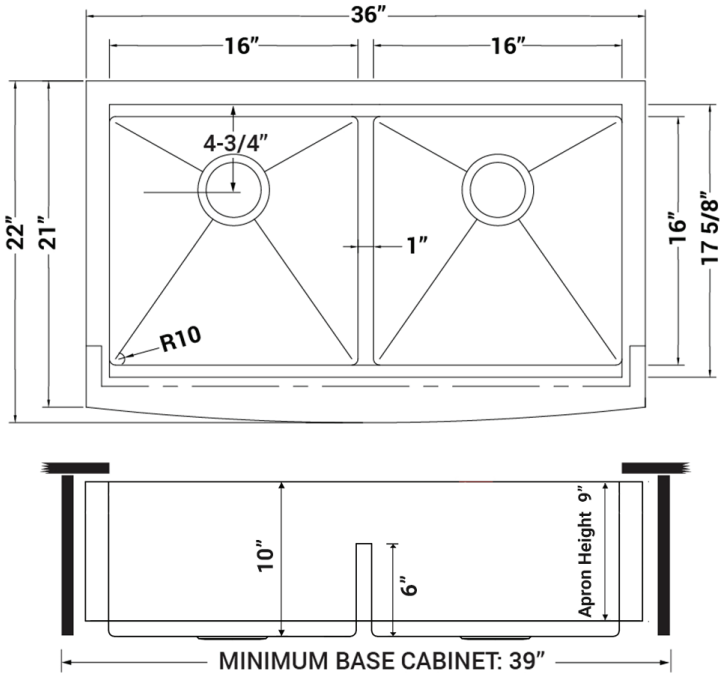

Register your product at www.ruvati.com/register.